



DBAT



DBAT-0xx

STRAP-ON THERMOSTATS

DBAT

FUNCTION

Single-stage fluid temperature control in metal pipes for heating, cooling and air conditioning plants.
Models with setpoint adjustment by knob on or under the cover, sensible element and mounting clamp for direct fixing on pipe.

APPLICATIONS

Well-suited for heating, cooling and air conditioning systems in strong polluted areas, domestic and industrial areas, commercial buildings, sport halls, storage room, garages, machine rooms, factories, greenhouses and agricultural installations.

TYPE	RANGE °C	HYSTERESIS K	MAX. BULB TEMP. °C	SPECIAL VERSIONS
DBAT-1	-30...+30	2...20	60	U
DBAT-3	0...+60	2...20	75	U
DBAT-4	0...+60	ST	75	U
DBAT-060	+5...+60	6±2	85	U
DBAT-090	+10...+90	6±2	85	U
DBAT-5	+20...+90	2...20	110	U

U knob under the cover
ST manual maximum reset

TECHNICAL FEATURES

Sensitive element: liquid-filled coiled copper bulb for contact
Contacts: dust-tight microswitches with SPDT contacts (heat/cool)
Switch capacity: 15 (8) A, 24...250 Vac
DBAT-0xx: 16 (4) A, 250 Vac / 6 (1) A, 400 Vac
see schedule
Differentials: see schedule
Working: -35...+65 °C
10...90% r.h. (non condensing)
Storage: -40...+70 °C
< 95% r.h.
Housing: Byblend base, ABS cover
DBAT-0xx: zinc-plated steel plate, not sealed ABS cover
Protection: IP65 (DBAT-0xx: IP40), class I
Size: 108 x 70 x 72 mm
DBAT-0xx: 38 x 55 x 105 mm
Weight: 180...500 g

NOTE

The range may be calibrated by tuning carefully the hexagon nut under

ELECTRICAL WIRING

Heating

Connect red terminal and blue terminal (fig. 2).
DBAT-090: connect terminal C and terminal 1 (fig. 3).
The contact opens during the temperature rising.

Cooling

Connect red terminal and white terminal (fig. 3).
DBAT-090: connect terminal C and terminal 2 (fig. 3).
The contact opens during the temperature dropping.
The respective free contact closes simultaneously (signal contact).

DBAT-x

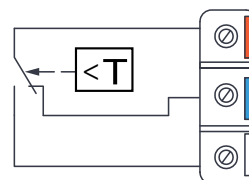

fig. 2

DBAT-0xx

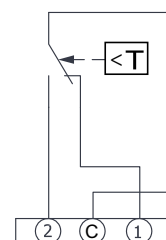

fig. 3

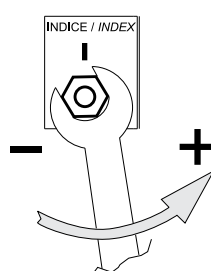
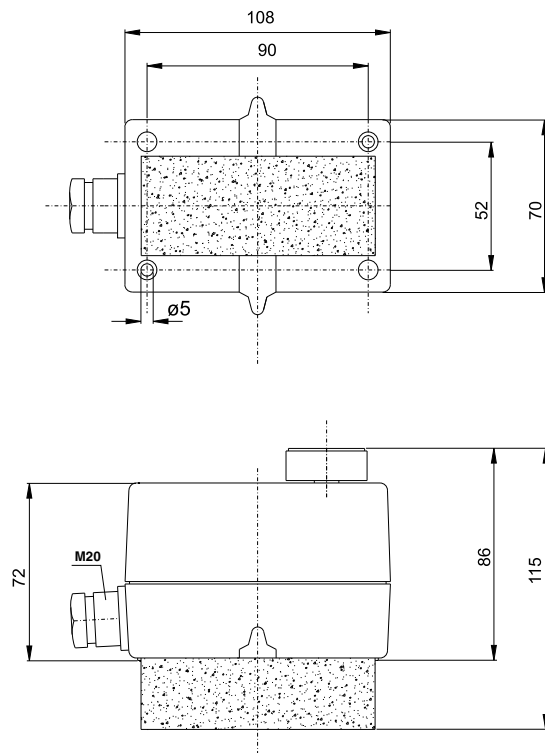

fig. 1

DIMENSIONS (mm)

DBAT-x



DBAT-0xx

